

COUNTRY HOMES & INTERIORS

WARM & COSY

THE NEW FARMHOUSE LOOK, FIRESIDE STYLE, SEASONAL FEASTS & TOASTY AUTUMN TRENDS

Decorating IDEAS

LUXURIOUS BEDS

ELEGANT DESIGNS FOR DINING ROOMS

HOW TO CREATE A LIGHTING SCHEME

THE RETURN OF GINGHAM & CHECKS

BLOOMSBURY REVISITED!

The artisans crafting the look today

Escape to the COUNTRY

◆ RETURN TO THE FARMHOUSE ◆ FAMILY HOME ON THE COAST ◆ HISTORIC BARN CONVERSION ◆ RUSTIC TIMBER-FRAME RETREAT

Inspired by the look of classic natural marble, the quartz surface worktops are more durable and impervious to stains, scratches and cracks



PROJECT PROFILE

Owners Lucy and Mark Dickinson live here with their family and pets

House A four-bedroom converted barn, dating back 500 years, in Kent

Project A new kitchen
Kitchen size 5x4m (excluding dining area)

Designer The team at Burlanes Interiors

Cabinetry Wellsdown kitchen painted in Mylands' Artillery Ground

Centuries OF STYLE

LUCY DICKINSON HAS RETAINED THE CHARACTER OF HER 500-YEAR-OLD BARN WHILE CREATING A STYLISH KITCHEN GEARED TO MODERN FAMILY LIFE



Ceramic tiles add a splash of graphic pattern and interest to the splashback behind the Aga cooker



The Aga heat storage cooker has two ovens and a side electric module with two more ovens for summer use

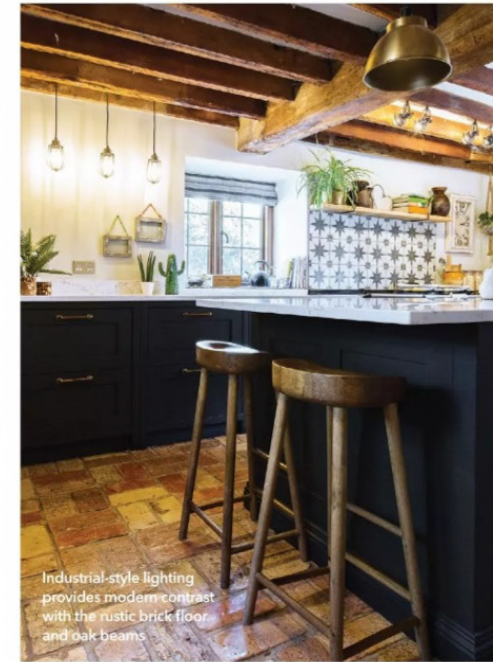

Industrial-style lighting provides modern contrast with the rustic brick floor and oak beams



Lucy chose a wall mural from the Natural History Museum archives to create a talking point in the dining area

After a decade living in their home, interior designer Lucy Dickinson, founder of Woolhouse Designs, and her husband, property developer, Mark, decided that it was time for a kitchen refresh. 'The cabinets were here when we moved in, so they had seen plenty of use and were looking very tired,' says Lucy. 'We also love to cook and entertain, but the existing layout wasn't very efficient.'

The couple share their home in a former wool merchant's barn with sons Harry, 21, and Tom, 17, with regular visits from their eldest, Josh, 24. They have two dogs, Olive and Orla, cats Zelda and Tigger, and a flock of chickens.

After working with local company Burlanes Interiors on the fitted furniture for her study, Lucy asked the team to create a bespoke design for the kitchen. 'Burlanes was a great company to work with, giving me lots of advice without ever being pushy,' says Lucy of the team, headed by managing director Danny Wood.

The hub of the room is now a large island, which forms a sociable focus to the space, surrounded by

base units, a wet zone and the Aga cooker, which they had inherited from the previous owners of the property. More storage, including a corner fridge, larder cupboard, breakfast station and admin dresser, run along the far wall to create task-specific zones, adding to the efficiency of the layout. 'By removing the wall cupboards, I have less physical storage space, but what I have is so much more efficient that it works a million times better,' says Lucy.

Eager to keep the rustic beauty of the existing reclaimed brick floor, Lucy chose the paint colours as the last stage of the project. 'I tried out different paint shades for the cupboards creating a rainbow of swatches in lots of colours, but in the end, settled on a rich, dark grey-brown shade because it worked so well with the floor, the Aga and touches of warm-coloured brass,' she explains. 'I balanced the dark colour with light worktops and neutral walls, which also help to accentuate the character of the beautiful oak beams and make them stand out.'

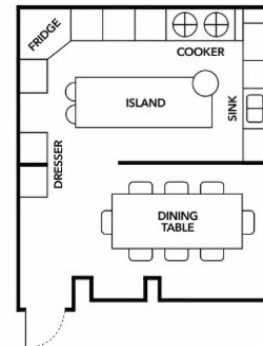

THE LAYOUT

A large island, measuring 2.6x1.2m, forms the central feature of the room, complete with storage, work surface and bar stools for socialising. It is surrounded by a wet zone with sink and dishwasher, cooking area with large Aga, corner fridge and larder and breakfast cupboards with dresser unit extending into the dining area and linking the rooms.



The whole stave oak chopping board can be moved to different corners of the island as the need arises

1 MOVEABLE CHOPPING BOARD

To make food prep easy, Burlanes designed and produced a bespoke whole stave oak chopping board with a custom-made support, so that it can be moved and securely fitted on to different corners of the island. Perfect for prepping veg near the sink and then moving them nearer to the cooker when needed. It can also be used as a serving station for snacks when friends sit at the island.

CENTURIES OF STYLE

3 CLEVER DESIGN SOLUTIONS

2 DRESSER & BREAKFAST CUPBOARD

Lucy wanted to include more storage, such as a tea and coffee station and somewhere for household paperwork. An original structural oak pillar meant she couldn't have one large cupboard. Instead, Burlanes created a breakfast cupboard on one side with double doors opening to a coffee maker and toaster, and drawers below for teabags and cutlery. On the other side is a household admin dresser with scalloped corbels to accentuate the unfitted look of the furniture, designed to suit the age of the house.

3 CORNER FRIDGE

Lucy wanted to include an extra-large fridge to suit the size of her family and for entertaining friends, but the original oak ceiling beams limited her options. She felt that a freestanding American-style fridge-freezer would have looked too dominant, while a single column design wouldn't be big enough. The solution was to include a corner model that makes use of the awkward space with almost 1,200 litres of energy-efficient fridge space - about double the amount of an American-style model.



The admin dresser, left, and breakfast cupboard, right, are built around an original structural pillar



The fully integrated corner fridge fits neatly below the beams and offers an impressive 1,160ltr of chilled storage

FEATURE AMELIA THORPE PHOTOGRAPHS SARAH LONDON PHOTOGRAPHY

THE DETAILS

INTERIOR DESIGN Lucy Dickinson, Woolhouse Designs

CABINETRY Wellsdown cabinetry, kitchen prices from £25,000, Burlanes Interiors. Painted in Artillery Ground wood and metal matt paint, £73 for 2.5ltr, Mylands

SURFACES Walls painted in Alderman marble matt emulsion, £53 for 2.5ltr, Mylands. White Attica engineered quartz worktops, from £550sq m, Caesarstone. Spitalfields Retro Star Black splashback tiles, £45sq m, Ca'Pietra. Lubelska brick terracotta floor tiles, £156.16sq m, Fired Earth

APPLIANCES Aga R3 Series Cream heat storage range cooker, from £8,240, Aga. The Corner fridge, £4,690, The Corner Fridge Company. RIF892 in-column integrated freezer, £399, Caple. SMD6EDX57G fully integrated dishwasher, £869, Bosch

SINKS & TAPS Phoenician mixer with rinse, £585, Perrin & Rowe. Nordic Round single boiling water tap, £950, Quooker. Classic Double Belfast sink, £437, Rangemaster

ACCESSORIES Brooklyn dome pendant lights, from £99 each; Orlando wire cage pendant lights, £49 each; Swivel double spotlights, £99 each set, all Industville. Weathered oak counter stools, £250 each, Cox & Cox. Blinds in Anoushka in Charcoal linen mix, £90m, Kate Forman

DINING AREA Natural History Museum Scarlet Ibis Eudocimus Ruber wallpaper mural, from £40, Surface View. Vintage antler chandelier, No1 Lewes